

MURRAY COUNTY

Section 9

Township 107

Range 40

10798 McGill-Warner Co., Blank Book Manufacturers, St. Paul.

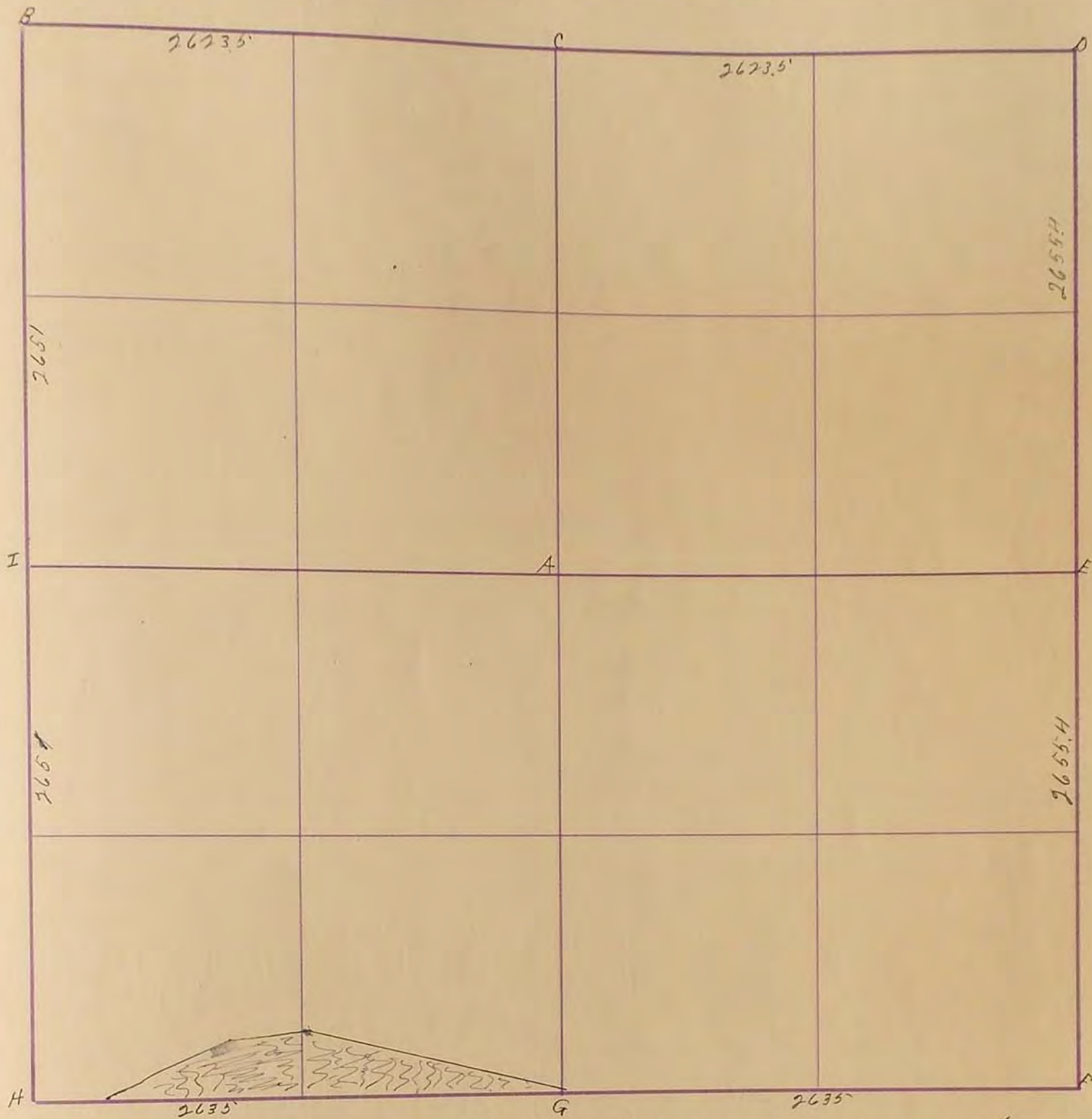

Surveyed road along south line of sect. 9 T 108 - R 40 with variation on account of slough as marked above.

Oct 25 1913

- A
 - B. Stone 9X14X20 grey bricks batts around cottonwood 2' 33' E X 33' W.
 - C. Stone 8X10X20 grey F. cor. 26' N. F. cor. 1' E of line 415
 - D. Stone see sec 3 Fence Post 33 ft east
 - E.
 - F. Stone 10X12X18 grey small stone around { F. Stone 14X24 on top flat 10" thick on N end 183 end
F. cor. 43' N.E. 44' N.W.
 - G. Stone in grade F. cor. 30 ft W.
 - H. " 10X12X16 broken tile around F. cor. 33' S on Sec. 17
F. cor. 34' N.E. H. (1913) Stone R.P. Twp 107 E 330 Post SW. 143
 - I. Established stone 10X10X26 N. gate Post 29.5' N.E.
S gate Post 30 feet F. cor. 58.6 SW F. cor. 47.5 N.W.
- J. H. Hoalsten Craft
- B. continuation of B West TP 33' N.E. F. cor. 37.6 N.W. TP Pole 51.0 S.W.

8
9
10
11
12
13
14
15

18
19
20
21
22
23
24
25
26
27
28
29
30
31
32
33
34
35
36

SURVEY No. 24

Section 9 Town 107 Range 40

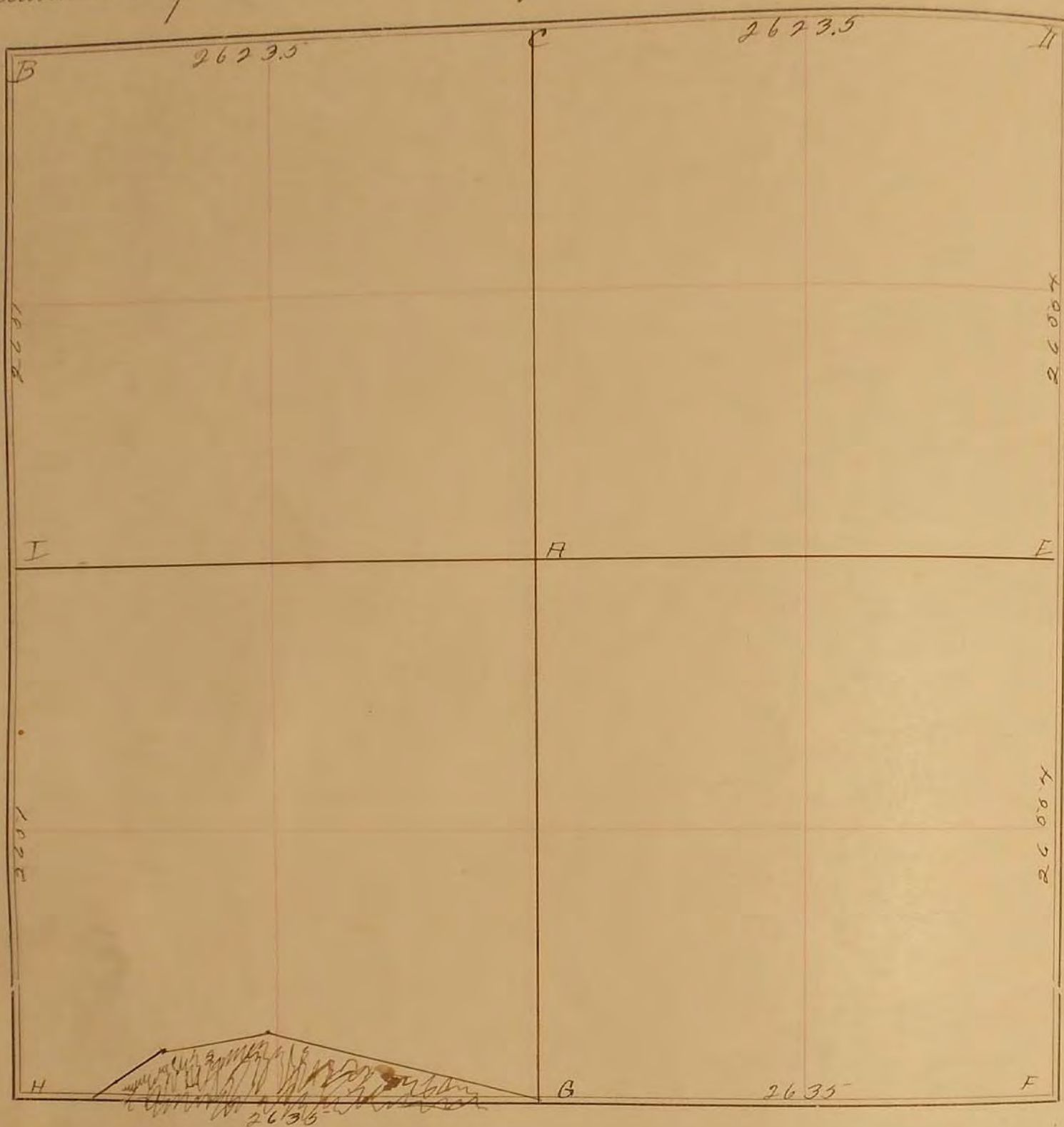

FIELD NOTES.

Surveyed road along south line of section 9 down 107
R. 40, with variation on account of slough as marked
above.

Oct. 25, 1913.

- B Stone 9x14x20 grey brick bats around. West T.P. 33' 11" E, F cor. 47.6 NW, T. Pole 51.0 SW
Cottonwood 2', 33.0 + 33' N.
- C Stone 8x10x20 grey Fence cor. 26' N, F cor 1' E. of line 41.5.
- H " See sec. 3. Fence post 33' east.
- E
- F Stone 10x12x18 grey small stones around. { Stone 14x24 on top, flat, 10" thick on N end + 18 on S end
F cor. 43' N.E. + 44' N.W.
- G Stone in grade, Fence cor. 30' N.
- H " 10x12x16 broken tile around. F cor. 33' S on sec. 17, F cor. 34' N.E.
- I ~~re~~ established Stone, 10x10x26 11 Gate post 27.5 NE, S Gate post 30'. F. cor. 58.6 SW, F. cor. 47.5 NW

J. W. Woolstenhulme